

7 SERIES CANADIAN



ELEVATION

— PARK MODEL COMPANY —





ELEVATION
— PARK MODEL COMPANY —

We look forward to pushing the boundaries of what's possible in a Park Model



Built to a higher standard

Elevation Park Model Company was born out of a need in the market for a new manufacturer with a different way of doing things. Seeing a growing demand for Park Model RVs across the country, and a shortage of product on dealers' lots, Brent Kattau and Joel Lederman decided to venture out on their own. With over 25 years of combined experience, they have covered many positions including parts, customer service, engineering, purchasing, and sales. Both were heavily involved in the innovation and design process for an established manufacturer. In the fall of 2021, they started construction of a 65,000 square foot modern production facility in Elkhart, Indiana and began assembling a group of well-established dealers to partner with.

Elevation's goal is to combine a passion for uplifting people to reach their potential, creating a team atmosphere where everyone feels valued, and a commitment to building the best quality product on the market. We look forward to pushing the boundaries of what's possible in a Park Model, providing a great experience for customers, an honest relationship with dealers, and family environment for our employees for many years to come!

Two handwritten signatures in black ink. The signature on the left is "Brent Kattau" and the signature on the right is "Joel Lederman".



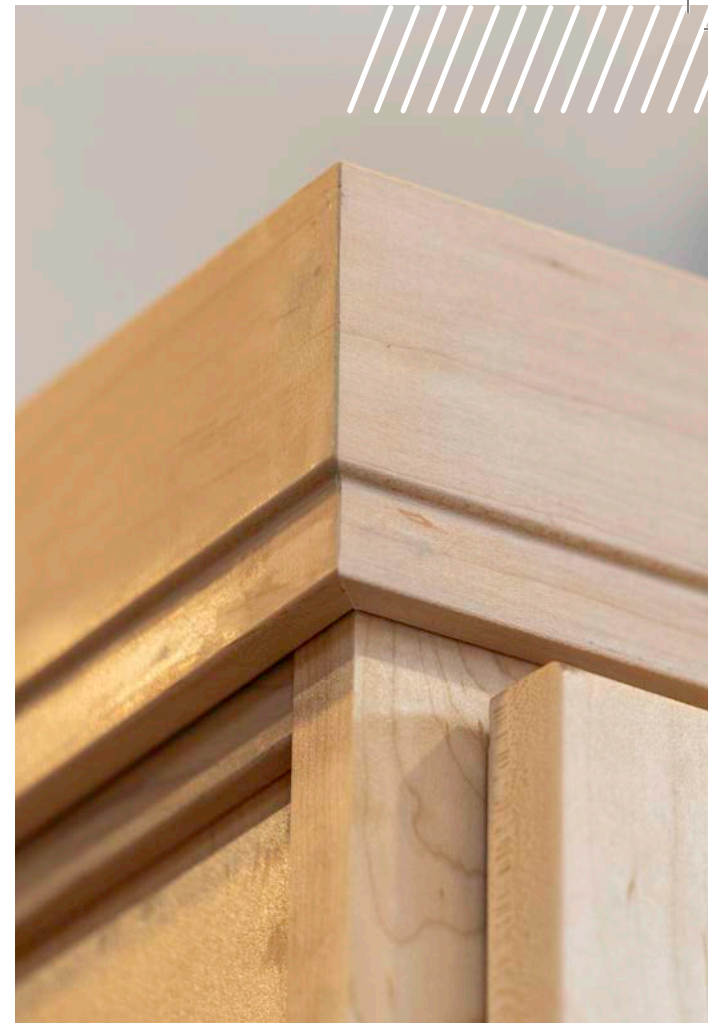

LEFT:
7 Series kitchen shown with Natural Stain cabinets,
Graphite Granite solid surface countertops,
black ceramic tile full height backsplash, black
farmhouse apron sink and Russo flooring.

MIDDLE:
7-114CA with Natural Stain cabinets & hardwood
trim, Graphite Granite solid surface countertops,
Salinas Oak ceiling, full height entertainment
center with Reclaimed Wood, and Russo flooring.



7-114CA





LEFT:
7-106CA kitchen shown with Polar White cabinets, Kamet solid surface countertops, full height Stone backsplash, black undermount sink & optional GE Café appliances.

RIGHT:
7-106CA bathroom with Piano Black cabinets, Kamet solid surface countertops, and a 60" walk in shower in White Marble.



7-106 CA



ABOVE LEFT: Full height wardrobe with Piano Black center drawers shown with optional Salinas Oak sliding barn doors

ABOVE RIGHT: 7-120CA Living Room featuring the 4 window & Traps front end with Slate Stain hardwood trim, and Russo flooring.

LEFT: 7-106CA kitchen featuring Polar White & Piano Black cabinets, moveable Island with Industrial barstools, and Dark Ash flooring.



7-120CA

7 Series Standard Features — Canadian

CONSTRUCTION

- Standing seam metal roof
- Anderson 100 Series Vinyl Windows (Black or White)
- 7/16" OSB Roof Decking w/ Ice & Weather shield
- 2x6 Perimeter Fascia
- Engineered Truss Rafters 16" o.c.
- Fixed Side Overhangs
- Metal Underbelly
- Premium color Vinyl Siding w/50 Year Warranty
- Vinyl Shakes or Board & Batten – Front end & Dormers
- Fiberglass Insulation: R-19 Sidewalls, R-22 Floors, R-33 Roof
- ZIP systems OSB w/ built in vapor barrier
- Metal Strapping Connecting Sidewalls to Floor
- 2x6 Sidewall Studs 16" o.c.
- 10" Steel I-Beam Frame
- 2x6 Floor joists 16" o.c.
- Floor ductwork w/ perimeter registers
- 5/8" Decking w/ water sealant
- 6' Vinyl Patio Door w/ Built in Blinds
- Customer selected front end window configuration
- Shed Dormers Entire Length
- Removable Hitch
- Metal Hurricane Straps

STANDARD FEATURES

- 50 Amp Electrical cord (36')
- Prep for Central Air
- Suburban 40,000 BTU Furnace
- 20-gallon electric W/H w/ lighted switch
- GE Appliance package w/ 22' French door or Side by Side refrigerator, 30" Over the Range Microwave, & 30" Gas Range – (Black, Stainless Steel, or Slate)
- Black or Stainless Steel farm apron or undermount sink
- Kohler Industrial kitchen faucet w/ pull down sprayer
- Island w/ Bar Stools or Table w/ Chairs
- Black, Brushed Nickel, or Gold hardware
- Kitchen Island Pendant Lights
- LED lights under Kitchen Cabinets
- Plywood construction Custom high-end staggered cabinetry w/ Slow close cabinet doors & drawers, 5 piece drawer fronts
- Real hardwood trim package including: cabinet crown, ceiling crown, baseboard molding, window & door trim, & under cabinet trim
- Toe Kicks in Cabinetry
- Solid Surface countertops throughout
- Full height tile or stone backsplash
- Raised Panel Solid core Interior Doors
- Cordless 2" Blinds
- LED can lights throughout
- Can lights in front overhang
- Ceiling Fan w/Light – Living Room & Bedroom
- Beautyrest 76 x 80 Standard King premium mattress
- Lift up bed box
- 2 Night Stands in Bedroom
- Master BRM hanging wardrobe w/ drawer bank
- Full height Entertainment center w/ Fireplace & wood mantle
- Wood feature material on ETC & in Bedroom
- Recliner Chair
- Queen Hide a bed sofa
- 60" Shower w/ Deluxe glass door & 2 head rain system
- Kohler Single Lever Bathroom Faucet
- Stainless Steel Bathroom Sink
- Kohler Residential Elongated Comfort Height Toilet
- Power bathroom vent
- TV Jack in LR & BRM
- 55" LG Smart TV in Living room, 43" LG smart TV in bedroom
- USB outlets in Kitchen & Bedroom
- Porch Lights by Each Door
- Exterior 110 GFI outlet
- Fire Extinguisher
- Smoke & CO2 Detector



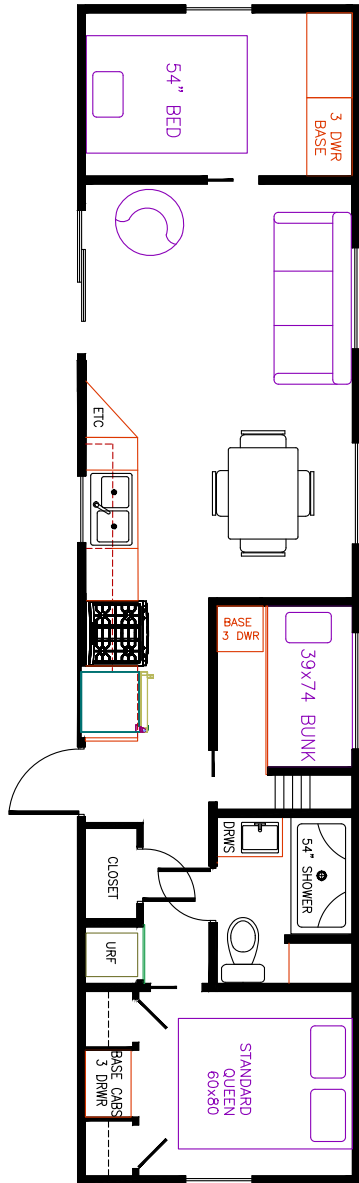

7-122CA

Elevation floorplans have been engineered to utilize the maximum 538 square feet in the most efficient way possible. Customers have the ability to choose between five front-end window designs, multiple bathroom layouts, and different wardrobe options, which are interchangeable in each floorplan. Many plans can accommodate amenities such as washer & dryer, dishwasher, larger refrigerator, or sectional sofa. Depending on the location of the unit, customers can select to have the floorplan flipped end-to-end or rolled side-to-side to best suit their needs.

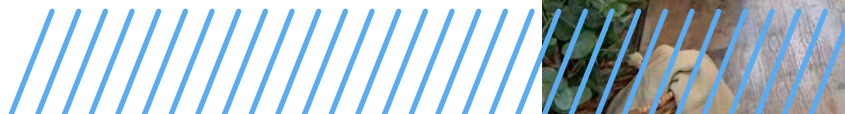



elevationparkmodels.com



Elevation Park Model Company

756 Patricia Ct.
Elkhart, IN 46516

574.501.3300   



*Products and options are subject to change based on availability.
Units are seasonal and not intended for full-time residence.*